

# NEMA 12 and 13 22mm Pushbutton Wall Mount



## Applications

- Designed to accept 22mm miniature oil-tight pushbuttons, switches and pilot lights.
- Provides protection from dirt, dust, oil and water.

## Construction

- Smooth continuously welded seams.
- Welded brackets provide for enclosure mounting.
- Captive cover screws thread into sealed wells.
- Larger enclosures provide internally hinged removable covers, designed to hold the cover open during wiring (see table).
- Oil-resistant gasket and adhesive.
- A bonding stud is provided on the door, and a grounding stud is provided on the enclosure.

## Finish

- Cover and enclosure are phosphatized and finished in ANSI 61 gray or RAL7035 light gray powder coating.

## Listings

- UL 508A Type 12 and 13 [UL File E65324]
- CSA Type 12 and 13 [CSA File LR21001]
- Complies with
  - NEMA Type 12 and 13
  - IEC 60529, IP54
- All appropriate components are required to maintain these standards.



### Shipping Schedule

Same day	1 - 15 days
----------	-------------

Color indicates shipping lead time in business days.

NEMA 12 and 13 22mm Pushbutton Wall Mount							
Part Number ANSI 61	Part Number RAL7035	Price	Size HxWxD	Drawing Link	# Holes	Steel Gauge	Hinged
MPB1	MPB1LG	\$55.50	3.56 x 3.06 x 3.66 [90 x 78 x 93]	PDF	1	14	No
MPB2	MPB2LG	\$62.00	5.44 x 3.06 x 3.67 [138 x 78 x 93]	PDF	2		
MPB3	MPB3LG	\$69.00	7.31 x 3.06 x 3.67 [186 x 78 x 93]	PDF	3		
MPB4	MPB4LG	\$76.00	9.19 x 3.06 x 3.67 [233 x 78 x 93]	PDF	4		
MPB6	MPB6LG	\$97.00	8.81 x 5.31 x 4.47 [224 x 135 x 114]	PDF	6		Yes
MPB9	MPB9LG	\$108.00	8.81 x 6.81 x 4.47 [224 x 173 x 114]	PDF	9		
MPB12	MPB12LG	\$120.00	10.69 x 6.81 x 4.47 [272 x 173 x 114]	PDF	12		

*Note: Dimensions in inches [millimeters].*

# NEMA 12 and 13 22mm Pushbutton Wall Mount



## Dimensions

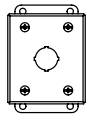
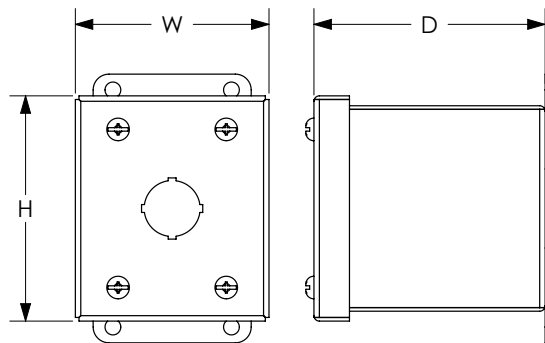

1

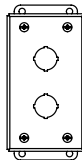

2

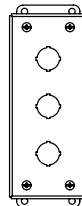

3

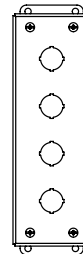

4

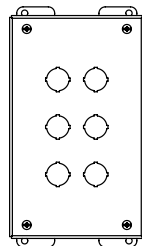

6

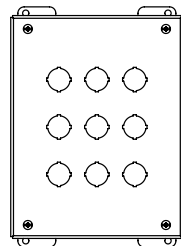

9

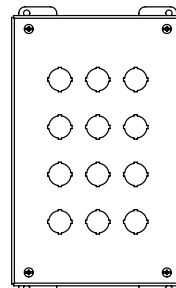

12

See our website: [www.AutomationDirect.com](http://www.AutomationDirect.com) for complete engineering drawings.